



Main Road  
Betley



 **Reposit**  
Rent without a deposit

£1,200 PCM

56 Merrial Street  
Newcastle under Lyme  
ST5 2AW  
01782 625734



Main Road  
Betley  
CW3 9AB

This impressive detached home set within the Betley conservation area offers country living in a beautiful semi rural village, with fields and open countryside beyond.

A substantial period property that has been lovingly upgraded throughout whilst retaining the original character. With a spacious living areas to the ground floor, fitted kitchen and orangery to to the ground floor and three double bedrooms with family bathroom to the first floor. Offering a wealth of charm and original features, in the heart of Betley, properties like this don't come available often!

Council Tax Band E. EPC Grade E. Long Term Let.  
Alternative deposit option available.

£1,200 PCM



### How does Reposit work?

			
<b>Choose.</b>	<b>Sign up &amp; pay.</b>	<b>Move in.</b>	<b>Check out.</b>
Ask us about Reposit instead of a traditional cash deposit.	You will receive an email to sign up and pay the Reposit fee on the Reposit platform.	Enjoy living deposit-free in your new home!	No waiting for your deposit back! Easily settle any amounts due, or raise a dispute via Reposit.





LOUNGE ONE	12'5" x 12'11" (3.779 x 3.926)
LOUNGE 2/DINING ROOM	10'9" x 12'11" (3.269 x 3.937)
KITCHEN	6'10" x 19'7" (2.094 x 5.979)
UTILITY ROOM	7'0" x 6'3" (2.124 x 1.898)
MASTER BEDROOM	12'10" x 12'3" (3.914 x 3.740)
BEDROOM 2	12'11" x 10'6" (3.932 x 3.197)
BEDROOM/STUDY	9'9" x 6'11" (2.970 x 2.099)
BATHROOM	6'10" x 6'4" (2.078 x 1.939)
CONSERVATORY	20'3" x 5'10" (6.160 x 1.777)



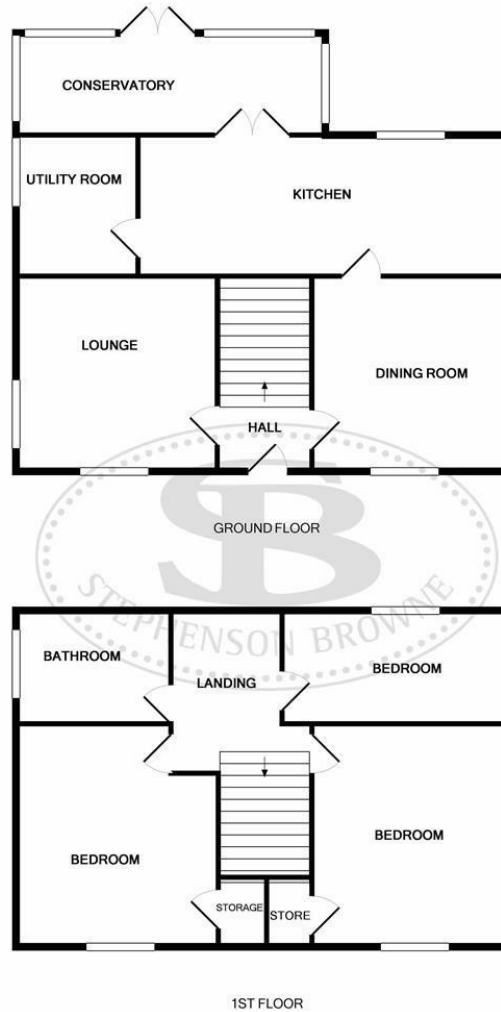

Whilst every attempt has been made to ensure the accuracy of the floor plan contained here, measurements of doors, windows, rooms and any other items are approximate and no responsibility is taken for any error, omission, or mis-statement. This plan is for illustrative purposes only and should be used as such by any prospective purchaser. The services, systems and appliances shown have not been tested and no guarantee as to their operability or efficiency can be given.  
Made with Metropix ©2016

# Stephenson Browne Estate Agents

Newcastle  
56 Merrial Street, Newcastle under Lyme  
Staffordshire, ST5 2AJ  
Tel: 01782 625734

Sandbach  
38 High Street, Sandbach  
Cheshire, CW11 1AN  
Tel: 01270 763200

Alsager  
13 Crewe Road, Alsager  
Stoke on Trent, ST7 2EW  
Tel: 01270 883130

**NOT TO SCALE** These floor plans are given as a guide only. Full completed measurements and details should be verified by any intending purchasers legal representative.

**NOTICE:** Stephenson Browne for themselves and for the vendors or lessors of this property whose agents they are give notice that: (1) the particulars are set out as a general guideline only for the guidance of intending purchasers or lessees, and do not constitute, nor constitute part of, an offer or contract; (2) all descriptions, dimensions, references to condition and necessary permissions for use and occupation, and other details are given in good faith and are believed to be correct but any intending purchasers or tenants should not rely on them as statements or representations of fact but must satisfy themselves by inspection or otherwise as to the correctness of each theme; (3) no person in the employment of Stephenson Browne has any authority to make representation or warranty whatever in relation to this property. (4) fixtures & fittings are subject to a formal list supplied by the vendors solicitors.